



1202 West Thomas Road, Phoenix, AZ 85013

# Arizona Rivers Workshop

May 12-14, 2008, 8:30 am - 4:30 pm

## Monday, May 12

Morning Session (DB106 at PC)  
8:30 Registration  
9:00 Introductions  
9:45 Break (15)  
10:00 Scientific methods  
11:10 Intro to GLOBE  
11:45 Lunch in HC4 at PC (45)  
Afternoon Session (DB106 at PC)  
12:30 Field methods  
2:00 Break (15)  
4:10 Field Trip Preparation  
4:30 Adjourn

## Tuesday, May 13

Morning Session (RSRP)  
8:30 Vans leave PC  
9-11:30 Rio Salado Field Site  
12:00 Lunch in HC4 at PC (45)  
Afternoon Session (DB106 at PC)  
12:45 Macro-invertebrates  
1:30 Data analysis  
2:00 Break (15)  
2:15 Field methods  
4:15 Field Trip Preparation  
4:30 Adjourn

## Wednesday, May 14

Morning Session (RSRP)  
8:30 Vans leave PC  
9-11:30 Rio Salado Field Site  
12:00 Lunch in HC4 at PC (45)  
Afternoon Session (DB106 at PC)  
12:45 Data Analysis  
2:15 Break (15)  
2:30 Implementation  
4:00 Evaluation & Graduation  
4:30 Adjourn

### Food and Drink:

Hardy lunches and beverages will be served at midday in the Hannley Center Room 4 (HC4). Water will be provided throughout the day. **You may want to bring snacks for break time** to keep your blood sugar up.

#### Lunch Menu:

May 12, 2008 Monday

- Tossed salad with two dressings
- Classic Italian lasagna
- Green Beans
- Garlic bread
- Dessert
- Ice tea, water and lemonade

May 13, 2008 Tuesday

- Assorted Wrap sandwiches
- Home made potato Chips
- Italian pasta Salad
- Brownies
- Ice tea, water and lemonade

May 14, 2008 Wednesday

- Assorted Sandwich Buffet
- Assorted bags of Chips
- Cole slaw
- Assorted cookies
- Ice tea, water and lemonade



### Classroom:

Our classroom is located at Phoenix College in the Dalby Building on 11 Ave in Room 106 (DB106). We will be meeting here every morning at 8:30 am and conducting all activities here with the exception of our two morning field trips. Visit <http://www.pc.maricopa.edu/map/> for more information about our classroom location.

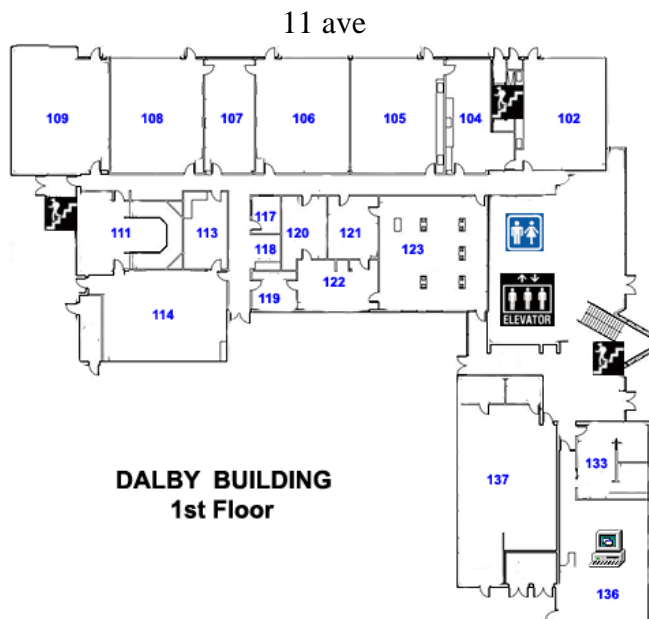

### Field Trip Information:

Our field site is the Rio Salado Restoration Project (RSRP). We will be at the north-side parking lot off Central. We will be walking on and off the trails on the north bank of the river over uneven ground covering a little less than a mile roundtrip. We will pause along the way to carry out a variety of study activities. Visit <http://phoenix.gov/riosalado/> for more information about the Restoration Project. Since we will be outside in the morning (9-11:30 am on Tuesday and Wednesday), we recommend light cotton, sturdy clothes that cover most of your body or plenty of sun cream. **A hat, sturdy shoes, sunglasses, and something to carry water are necessary.**

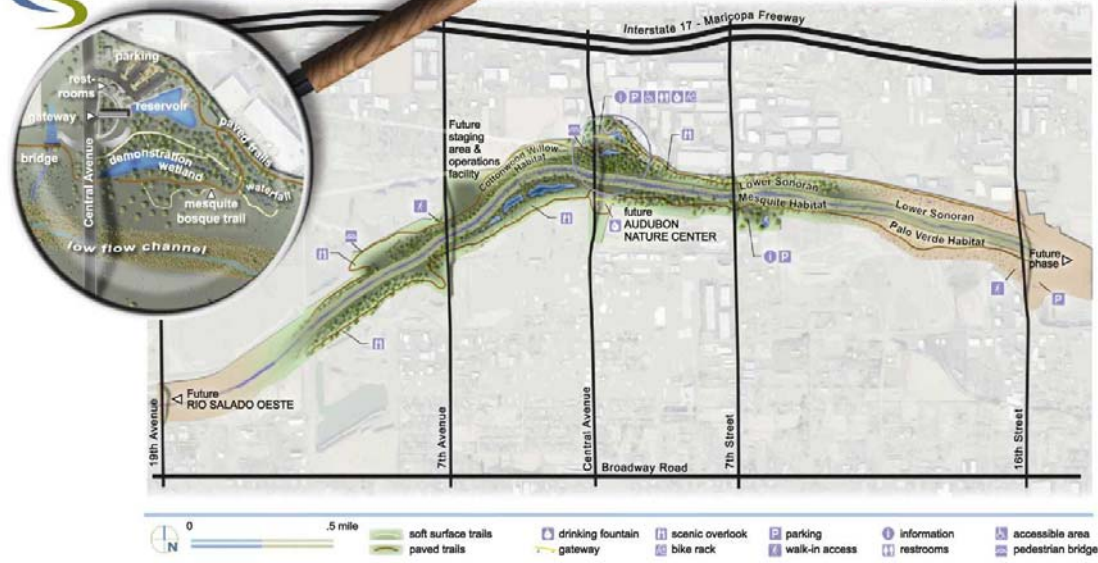

**Emergency Contact Information:**

Please, bring the name address and phone number of a person who would be available during workshop hours who is able and willing to act as an emergency contact. If you are a minor this should be your parent or guardian.

**Materials:**

Please, bring a three ring binder, filler paper, pencil and pen. We will be providing three hole punched materials to add to your binder.